

SYLVANIA Luminaires

Installation Guide - EDGE-LIT PANEL



The Edge-Lit Panels are environmentally preferable LED alternatives to traditional fluorescent luminaires, offering up to 47% in energy savings. Ideal in place of traditional luminaires, or as new installations, the Edge-Lit Panels are offered in three sizes for illuminating offices, retail or hospitality areas.

For warranty coverage, please register at www.sylvania.com/warrantyregistration.

⚠ WARNING

- TO PREVENT PERSONAL INJURY OR PRODUCT DAMAGE ONLY LICENSED ELECTRICIANS SHOULD PROVIDE ALL INSTALLATION SERVICES.
- TO AVOID ELECTRIC SHOCK OR COMPONENT DAMAGE DISCONNECT POWER BEFORE ATTEMPTING INSTALLATION OR SERVICING.
- THIS PRODUCT MUST BE INSTALLED IN ACCORDANCE WITH THE NATIONAL ELECTRIC CODE (NEC) AND ALL APPLICABLE FEDERAL, STATE AND LOCAL ELECTRIC CODES AND SAFETY STANDARDS.
- USE CAUTION WHEN HANDLING THIS PRODUCT DURING OR AFTER OPERATION AS IT MAY BECOME HOT AND CAUSE BURNS. DISCONNECT PRODUCT AND ALLOW COOLING PRIOR TO SERVICING.
- ANY ALTERATION OR MODIFICATION OF THIS PRODUCT IS EXPRESSLY FORBIDDEN AS IT MAY CAUSE SERIOUS PERSONAL INJURY, DEATH, PROPERTY DAMAGE AND/OR PRODUCT MALFUNCTION.
- TO PREVENT PRODUCT MALFUNCTION AND / OR ELECTRICAL SHOCK THIS PRODUCT MUST BE PROPERLY GROUNDED.
- THIS LUMINAIRE IS DESIGNED TO OPERATE IN AMBIENT TEMPERATURES RANGING FROM -4°F TO +104°F (-20°C TO +40°C) EMERGENCY BACKUP +32°F TO +104°F (0°C TO +40°C) AND TO BE MOUNTED WITH THE LEDS FACING DOWN.

SAFETY PRECAUTIONS:

IMPORTANT: READ CAREFULLY BEFORE INSTALLING THE FIXTURE. RETAIN FOR FUTURE REFERENCE.

GENERAL: Upon receipt of the fixture, thoroughly inspect for any freight damage which should be brought to the attention of the delivery carrier.

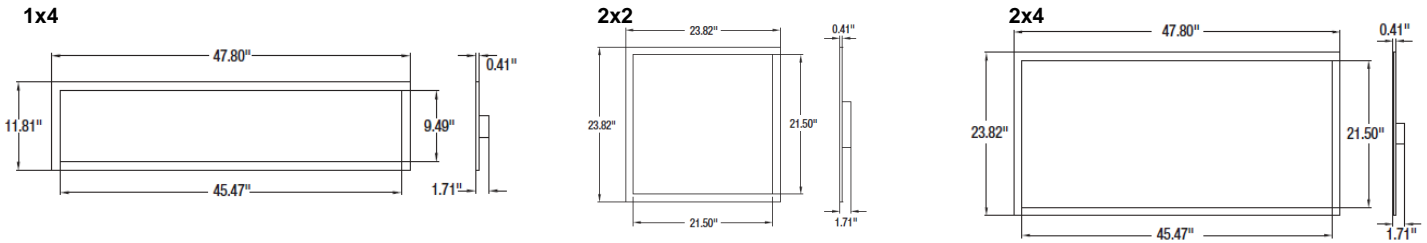

INSTALLATION:

1. Disconnect power to fixtures.
2. Remove ceiling tile(s) where the Edge-Lit Panel will be installed, and remove adjacent tiles to make electrical connections.
3. Raise luminaire into hole in the ceiling, above the T-bar. (See Figure 1)
4. Slowly rest luminaire on T-bar and make sure the fixture fits appropriately before wiring. (See Figure 2)
5. **Installing Earthquake Clips:** (See Figure 3)
 - a. Locate all four earthquake clips on back of luminaire.
 - b. Pull each tab to upright position and then twist towards T-bar.
 - c. Rest on T-bar to hold luminaire in place.
6. Attach safety cable (provided by others) through hole attached to the earthquake clips. (See Fig.4)
7. **For Emergency Battery Backup:** See page 3 for wiring instructions. Ensure that all parts are removed from product packaging before discarding packaging.
8. **For Standard Versions:** Connect the incoming electrical wires to the set of power wires black to black (hot), white to white (neutral) and green to green (ground). (See Wiring Diagram 1) *(Please note: The lowest wire gauge compatible with terminal block is 14 gauge)*
9. Installation is now complete. Turn on the power at circuit breaker or fuse box, then turn the light switch to power the fixture.

Figure 1

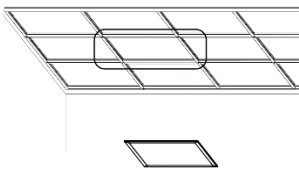
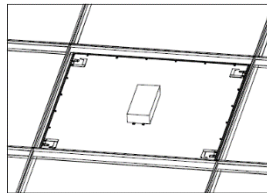

Figure 2



Wiring Diagram 1

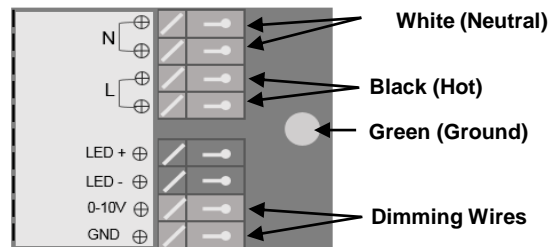

Figure 3

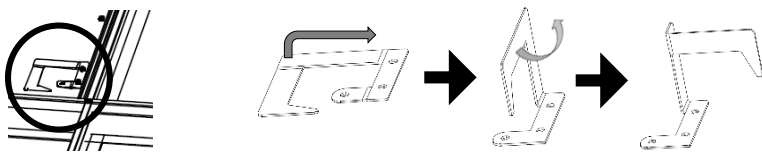
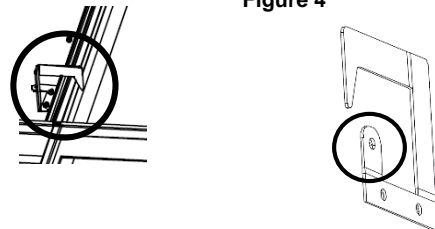

Figure 4



CONNECTING EMERGENCY BATTERY BACKUP AND INSTALLING TEST BUTTON:

Connecting the Emergency Battery Backup:

1. Open the octagonal junction box located in the top of the panel.
2. Connect the wires as indicated in Connection A (incoming unswitched power line to black wire, incoming common to white wire, ground to green wire and the incoming switched power line to the white and blue striped wire).
3. Close octagonal junction box by replacing screws.

Installing the Emergency Test Button:

1. Remove ceiling tile where test button is to be installed.
2. Remove nut from backside of test button and set aside.
3. Remove screws that connect test button front plate and junction box and set screws aside.
4. Insert test button into front plate so that the red button is on the same side as the wording of the front plate. Replace the nut onto the backside of the test button, ensuring a snug fit.
5. Cut a hole in the ceiling tile slightly smaller than the opening of the square junction box on the desired location on the tile.
6. Remove a knockout from the junction box by bending back and forth until the knock out breaks off.
7. Insert flex conduit end in to the junction box and secure in place.
8. Place junction box on top of the opening.
9. Connect both ends of the converter connector (See Connection B).
10. Connect both ends of the test button connector (See Connection C).
11. Place front over opening aligning holes and screw the front plate and junction box together.
12. Replace tile with emergency test button into ceiling.
13. Replace adjacent ceiling tiles.

Emergency battery backup is now installed.

If installed correctly battery backup button will glow red and once the button is pressed luminaire will dim to emergency level. Once the button is released the luminaire will turn off momentarily before returning to original output.

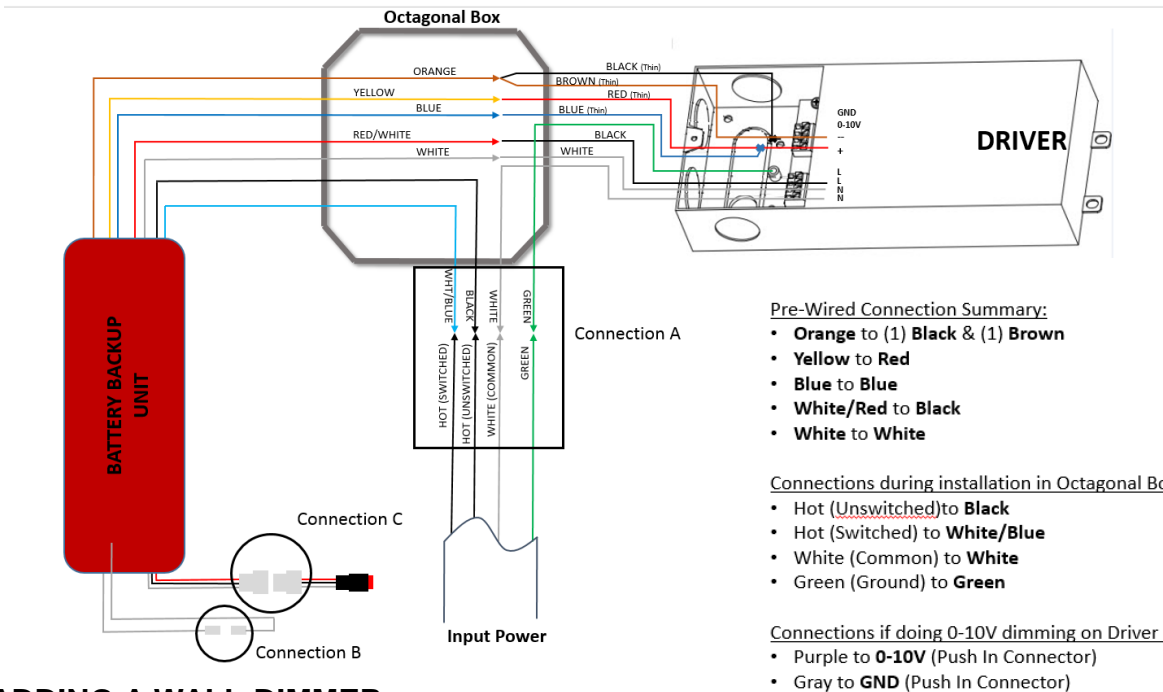

ADDING A WALL DIMMER

This fixture is compatible with 0-10V output dimming controls. Using the 0-10V dimming the light output will range from 10% - 100%. To get to 0% light output (OFF) it is necessary to disconnect the input power from the LED drivers. This can easily be done by inserting a relay/switch between the line and load connectors inside the fixture. Connect dimmer or wall switch to dimming inputs on driver. (See Wiring Diagram 1)

CLEANING AND MAINTENANCE

- To maintain the fixture efficacy occasional cleaning of the outer lens surface may be needed.
- Use a mild soap or detergent, which is essentially neutral pH (pH approximately 6 to 8), nonabrasive, and which contains no chlorinated or aromatic hydrocarbons.
- Wash thoroughly, using a soft cloth.
- Rinse with clean, cold water and wipe dry.



TROUBLE SHOOTING CHECKLIST: If luminaire does not work

- Check your power source.
- Check electrical connections.