

## Pipe Straps, Conduit Clamps and Hangers

### Pipe Clamps — A-726, Alloy Three-Bolt Pipe Clamp

Designed for hot-insulated pipelines. The spacer on the top inner bolt provides uniform space for the connecting eyerod or weldless eyenut.

Temperature range: above 750° F (399° C) to 1050° F (566° C).

- Specifications**
- Material: Chromium Molybdenum Steel, ASTM A-387 Grade 22
  - Compliance: Federal Specification A-A-1192A Type 3, MSS-SP-69 Type 3 and BSPSS-BS3974
  - Finish: Standard Finish — GoldGalv®, Black (add suffix “-B”), Electro-Galvanized (add suffix “-EG”)
  - Ordering: Specify catalog number and pipe size

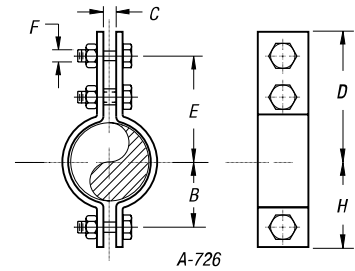

CAT. NO.	PIPE SIZE (IN.)	MAXIMUM LOAD			B (IN.)	C (IN.)	D (IN.)	TAKE OUT E (IN.)	F (IN.)	H (IN.)	(LBS.)
		950° F/510° C	1000° F/538° C	1050° F/566° C							
A-726-3/4	3/4	870	600	440	1 1/8	5/8	3	2 1/2	3/8	1 1/2	1.09
A-726-1	1	870	600	440	1 1/4	5/8	3 1/2	2 5/8	3/8	1 3/4	1.14
A-726-1-1/4	1 1/4	870	600	440	1 1/2	3/4	3 3/4	2 7/8	3/8	2 1/4	1.23
A-726-1-1/2	1 1/2	1,400	1,000	700	1 3/4	1	4 1/2	4 1/8	3/8	2 3/4	2.48
A-726-2	2	1,400	1,000	700	2 1/8	1	5 1/2	5 1/8	3/8	2 3/4	2.70
A-726-2-1/2	2 1/2	1,400	1,000	700	2 1/4	1	6 1/2	5 5/8	3/8	3	2.76
A-726-3	3	1,400	1,000	700	2 3/4	1	6 3/4	6	3/8	3 1/2	3.19
A-726-4	4	2,300	1,600	1,100	3 3/8	1	7 3/4	6 1/2	3/4	4 1/2	7.30
A-726-5	5	2,300	1,600	1,100	4	1 1/8	8 1/2	7	3/4	5 1/2	7.96
A-726-6	6	2,600	1,800	1,300	4 3/4	1 1/4	10	8 5/8	7/8	6 1/2	12.26
A-726-8	8	2,600	1,800	1,300	5 3/4	1 1/4	11	9 5/8	7/8	7 1/2	14.04
A-726-10	10	3,000	2,100	1,500	6 3/4	1 1/4	12	10 1/2	1	8 1/4	21.33
A-726-12	12	3,000	2,100	1,500	8 3/4	1 1/2	13 1/2	11 1/8	1	9 1/2	24.00
A-726-14	14	3,900	2,800	2,000	9 3/4	2	14 1/2	12 1/4	1 1/4	10 3/4	38.78
A-726-16	16	3,900	2,800	2,000	10	2	15 1/2	14	1 1/4	11 1/4	43.13
A-726-18	18	39	2,800	2,000	11 3/4	2	16 3/4	15 1/2	1 1/4	13 1/4	47.78
A-726-20	20	5,000	3,200	2,000	12 3/4	2	17 1/2	15 3/4	1 1/2	14	58.67
A-726-24	24	5,500	3,500	2,700	14 3/4	1 1/2	19 1/2	17 1/2	1 1/2	16 3/4	90.82

Standard Finish — GoldGalv®, unless otherwise stated.

### Pipe Hangers — C-710, C-710F, C-710P, C-710SS

Designed to support non-insulated, stationary lines from above, allowing for approximately 1" to 1 1/2" of vertical adjustment after the pipe is in place. The lower nut (not furnished) adjusts the pipe line to the proper elevation, the top nut (not furnished) prevents loosening due to vibration and must be tightened securely to assure proper hanger performance.

Rated Loads are for up to 650° F (343° C) for carbon steel. Maximum PVC temperature is 140° F (60° C).

- Specifications**
- Material: Carbon Steel (Also available in Stainless Steel as C-710SS)
  - Compliance: Federal Specification A-A-1192A Type 1, MSS-SP-69 Type 1, BSPSS-BS3974, UL and FM
  - Finish: Standard Finish — GoldGalv®, Black (add suffix “-B”), Electro-Galvanized (add suffix “-EG”)
  - Ordering: Specify catalog number, finish and pipe size

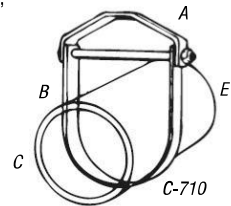

CAT. NO.	PIPE SIZE (IN.)	MAX. LOAD (LBS.)	A (IN.)	B (IN.)	C (IN.)	ROD TAKE OUT E (IN.)	WT. EACH (LBS.)
C-710-1/2	1/2	610	3/8	2 3/4	3 1/2	1 1/8	.27
C-710-3/4	3/4	610	3/8	2 1/2	2 1/2	1 1/2	.29
C-710-1	1	610	3/8	3	3 3/4	2 1/4	.33
C-710-1-1/4	1 1/4	610	3/8	3 3/8	4	2 1/4	.36
C-710-1-1/2	1 1/2	610	3/8	3 1/4	4 1/4	2 3/8	.42
C-710-2	2	610	3/8	3 3/8	4 3/4	3 1/8	.52
C-710-2-1/2	2 1/2	1,130	1/2	4 1/2	5 1/2	3 1/2	.61
C-710-3	3	1,130	1/2	5	6 1/4	4 1/2	.90
C-710-3-1/2	3 1/2	1,130	1/2	4 1/2	6 3/4	3 3/4	.99
C-710-4	4	1,430	3/4	5 3/4	7 3/4	4 3/4	1.40
C-710-5	5	1,430	3/4	6	8 3/4	5	2.10
C-710-6	6	1,940	3/4	7	10 1/2	5 3/4	3.00

Standard Finish — GoldGalv®, unless otherwise stated.

CAT. NO.	PIPE SIZE (IN.)	MAX. LOAD (LBS.)	A (IN.)	B (IN.)	C (IN.)	ROD TAKE OUT E (IN.)	WT. EACH (LBS.)
C-710-7	7	2,000	3/4	7 3/4	11 1/4	6 1/2	5.42
C-710-8	8	2,000	3/4	8 1/2	12 1/4	6 3/4	5.25
C-710-10	10	3,600	7/8	10	15 1/8	8 1/4	9.10
C-710-12	12	3,800	7/8	11 1/8	17 1/2	9 1/4	11.75
C-710-14	14	4,200	1	12 1/2	19 1/2	10 3/8	14.25
C-710-16	16	4,800	1	15	23	13 1/8	20.75
C-710-18	18	4,800	1 1/4	15 3/4	24 3/4	13 3/4	23.00
C-710-20	20	4,800	1 1/4	17 1/2	27 3/4	15 1/4	41.50
C-710-24	24	4,800	1 1/4	19 3/4	31 1/2	17 1/2	50.00
C-710-30	30	6,000	1 1/4	24 3/4	40 3/4	21 3/4	68.08
C-710-36	36	9,500	1 1/2	32 1/2	50 1/2	30	68.68

Standard Finish — GoldGalv®, unless otherwise stated.